

Product data

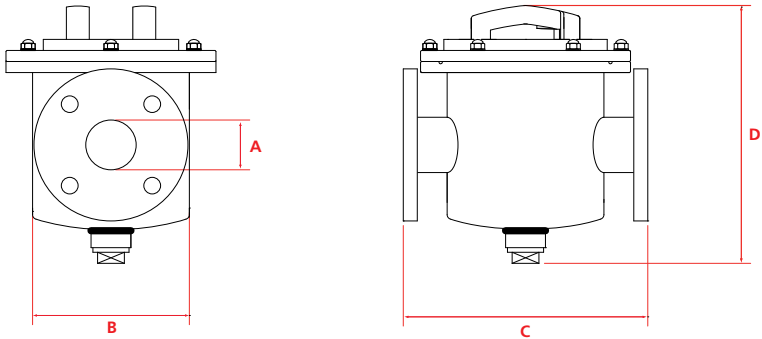

Item Code	Part No.	Inlet / Outlet Dia. A	Filter Dia. B	Flange spacing C	Height D	No. magnetic rods	**Flow rate gallons/minute (m³/hour)	Weight lbs/kgs
BMXT/1.5	BMXT100/ANSI	1.5" / 38mm	4" / 100mm	10" / 250mm	11" / 280mm	3	40 (9)	20 / 9
BMXT/2	BMXT150/ANSI	2" / 50mm	6 ¾" / 170mm	11 ½" / 280mm	11" / 280mm	5	79 (18)	42 / 19
BMXT/3	BMXT200/3/ANSI	3" / 75mm	8 ¾" / 220mm	14 ½" / 360mm	13 ¼" / 335mm	7	229 (52)	82 / 37
BMXT/4	BMXT200/ANSI	4" / 100mm	8 ¾" / 220mm	14 7⁄8" / 380mm	13 ¼" / 335mm	7	308 (70)	82 / 37
BMXT/6	BMXT300HF/ANSI	6" / 150mm	12 ¾" / 325mm	19 ¼" / 490mm	16 ½" / 420mm	9	440 (100)	133 / 60
BMXT/8	BMXT300HF/8/ANSI	8" / 200mm	12 ¾" / 325mm	20 ¾" / 525mm	18 ½" / 460mm	9	950 (215)	140 / 64
BMXT/10*	BMXT400/10/ANSI*	10" / 250mm	16" / 406mm	30" / 760mm	29 ¾" / 754mm	16	968 (220)	190 / 86
BMXT/12*	BMXT400/12/ANSI*	12" / 300mm	16" / 406mm	30" / 760mm	29 ¾" / 754mm	16	1364 (310)	195 / 88

* Made to order sizes
** Based on flow velocity of 6-8 ft/sec.

Performance
Magnetic performance 9,000 Gauss high strength
Performance reading On tube surface
Magnetic material Rare Earth Neodymium Iron Boron N42SH
Temperature 41° to 302°F / 5° to 150°C (212°F / 110°C if using automatic air vent)
Operating pressure +/- 174psi / 12 bar (145psi / 10 bar if using automatic air vent)
Drain valve ¾" NPT on BMXT/1.5 (BMXT100/ANSI), all others 1 ¼" NPT

Materials
Housing 304 grade stainless steel
Tube cartridge 316 grade stainless steel – aerospace quality
Other parts 304 grade stainless steel
Surface finish Internal - bead blast
External - powder coated, black
Viton o-ring, brown

Sealing

Includes
Optional automatic air vent

Options
High temperature Samarium Cobalt magnetic material +482°F / 250°C

Warranty
Industry leading 10 years

BoilerMag North America
442 Millen Road, Unit #9, Stoney Creek, Ontario L8E 6H2, Canada
T 1-800-260-2124 F 905-664-7090
sales@eclipsetoolsinc.com www.boilermag.com/na

While every effort has been made to ensure the accuracy of the information in this publication please note that specifications may change without notice.



Prevents build up of black sludge

BoilerMagXT Full Flow Filter

Cost Effective Protection For Larger Sized Properties

BoilerMagXT is a range of high specification **full flow filters** for large industrial sized heating and cooling systems. BoilerMagXT features a robust fabricated stainless steel construction which is ideal for the most demanding of applications.

With model sizes compatible for 1½” up to 12” port sizes and ANSI flanges, BoilerMagXT easily handles the efficiency and reliability demands of large industrial heating and cooling systems.

It provides long lasting protection for system components such as heat exchangers, pumps and radiators.

- Easy installation – fits standard ANSI flanged connections
- Simple to service and clean – no need to disconnect
- Operating temperature up to 302°F
- Operating pressure up to 174 psi
- Flow rates up to 1364gpm*
- Full flow – filters 100% of fluid
- Minimal pressure reductions
- Huge dirt collection capacity
- No on-going running costs

*Based on flow velocity of 6-8ft/sec



Full Stainless Steel Construction
BUILT TO LAST!

Getting To Know Your BoilerMagXT

It removes black sludge, improving system performance and reducing maintenance.

Installation

BoilerMagXT is generally installed on the return circuit as close to the boiler as possible. On larger systems smaller units may be installed elsewhere giving extra protection for radiators and pipework.

Cleaning

Cleaning is simple: isolate the inlet and outlet valves and release the nuts on the lid. Remove the contaminated cartridge from the housing and remove the magnetic cores from the tube assembly. The attracted contamination can then be removed, quickly and easily.

Installation options

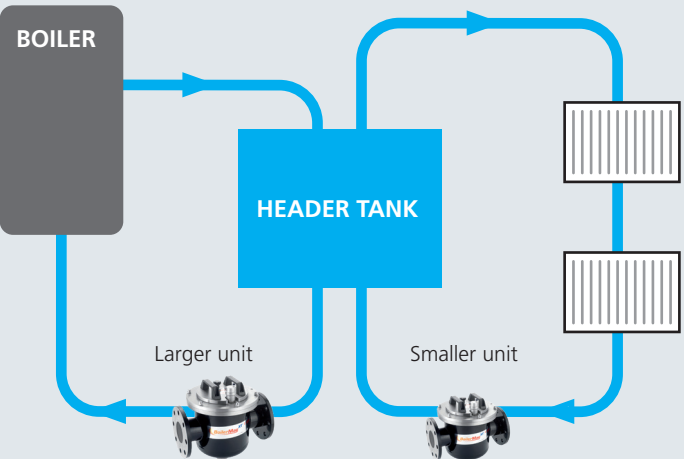

Heating & Cooling System Protection

All heating systems are at risk from magnetite (black sludge) which forms when water reacts with ferrous components. Left unchecked, this can seriously reduce energy efficiency and cause premature failure of components, resulting in high maintenance costs.

BoilerMag High Performance Filters

BoilerMag high performance filters have been carefully engineered to provide lasting protection for larger heating and cooling systems. Powerful magnetic circuits combined with optimized fluid flow dynamics ensure that virtually every particle of magnetite (black sludge) is removed on first pass through the filter, thereby improving efficiency and protecting system components.



Added Protection Against Corrosion



In addition to providing protection against magnetite (black sludge), BoilerMagXT units are supplied with Automatic Air Vents.

Air is a catalyst and enables corrosion to develop in heating and cooling systems. It can be trapped in the system when commissioned or released naturally when cold water is heated. This can result in excessive noise, reduction in flow rates, reduced heat exchange and corrosion.

BoilerMag's Automatic Air Vent continually releases air without any manual intervention, significantly reducing the risk of problems outlined above.

Full Flow Design - Filters 100% of Water on First Pass

A full flow filter is fitted in-line within the main circulation, ensuring 100% of system water passes through on each pass. It is vital that magnetite is extracted immediately from the circulation before it reaches the boiler. The alternative side stream filter method allows magnetite to circulate several times and may never be captured.



Full Flow Filtration

A clean, energy efficient system

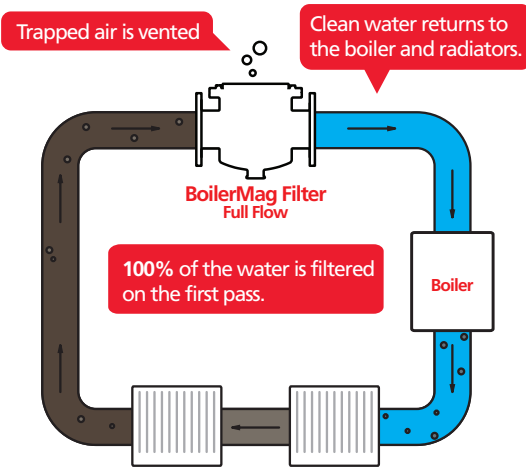

Side Stream Filtration

A contaminated, inefficient system with a boiler prone to failure

